

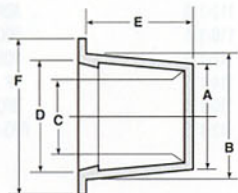

PLUGS non-threaded

T Series Tapered Plugs (cont'd)

Caplug No.	Dimensions												Packaging				Caplug No.
	A		B		C		D		E		F		Standard Carton		Mini Pak Quantity		
	in	mm	in	mm	in	mm	in	mm	in	mm	in	mm	Shipping Wt.(Approx.) lbs	kgs		No. of Pieces	
<i>T-00</i>	.116	2.95	.182	4.62	.053	1.35	.120	3.05	.38	9.65	.31	7.87	2	0.9	5000	1000	<i>T-00</i>
<i>T-00-S</i>	.140	3.56	.180	4.57	.088	2.24	.109	2.77	.22	5.59	.31	7.87	4	1.8	5000	1000	<i>T-00-S</i>
<i>T-00-X</i>	.145	3.68	.205	5.21	.079	2.01	.150	3.81	.38	9.65	.41	10.41	3	1.3	5000	1000	<i>T-00-X</i>
<i>T-0</i>	.173	4.39	.240	6.10	.111	2.82	.177	4.50	.38	9.65	.38	9.65	3	1.3	5000	1000	<i>T-0</i>
<i>T-1</i>	.236	5.99	.302	7.67	.174	4.42	.240	6.10	.38	9.65	.44	11.18	3	1.3	5000	1000	<i>T-1</i>
<i>T-1-X</i>	.267	6.78	.335	8.51	.205	5.21	.273	6.93	.38	9.65	.47	11.94	4	1.8	5000	1000	<i>T-1-X</i>
<i>T-2</i>	.299	7.59	.365	9.27	.235	5.97	.302	7.67	.38	9.65	.50	12.70	4	1.8	5000	1000	<i>T-2</i>
<i>T-2-S</i>	.325	8.26	.367	9.32	.263	6.68	.305	7.75	.19	4.83	.50	12.70	3	1.3	5000	1000	<i>T-2-S</i>
<i>T-2-X</i>	.330	8.38	.396	10.06	.267	6.78	.333	8.46	.38	9.65	.53	13.46	4	1.8	5000	1000	<i>T-2-X</i>
<i>T-3</i>	.361	9.17	.427	10.85	.298	7.57	.365	9.27	.38	9.65	.56	14.22	5	2.2	5000	1000	<i>T-3</i>
<i>T-3-X</i>	.390	9.91	.456	11.58	.327	8.31	.394	10.01	.38	9.65	.59	14.99	6	2.7	5000	1000	<i>T-3-X</i>
<i>T-4</i>	.419	10.64	.485	12.32	.356	9.04	.422	10.72	.38	9.65	.63	16.00	6	2.7	5000	1000	<i>T-4</i>
<i>T-4-X</i>	.447	11.35	.513	13.03	.385	9.78	.451	11.46	.38	9.65	.66	16.76	6	2.7	5000	1000	<i>T-4-X</i>
<i>T-5</i>	.471	11.96	.547	13.89	.409	10.39	.485	12.32	.44	11.18	.69	17.53	7	3.1	5000	1000	<i>T-5</i>
<i>T-5-S</i>	.533	13.54	.562	14.28	.477	12.12	.506	12.85	.22	5.59	.68	17.27	5	2.2	5000	1000	<i>T-5-S</i>
<i>T-5-X</i>	.500	12.70	.576	14.63	.440	11.18	.516	13.11	.44	11.18	.72	18.29	7	3.1	5000	1000	<i>T-5-X</i>
<i>T-6</i>	.532	13.51	.608	15.44	.468	11.89	.545	13.84	.44	11.18	.75	19.05	8	3.6	5000	1000	<i>T-6</i>
<i>T-6-S</i>	.554	14.07	.612	15.55	.490	12.45	.551	14.00	.31	7.87	.75	19.05	6	2.7	5000	1000	<i>T-6-S</i>
<i>T-6-X</i>	.550	13.97	.631	16.03	.487	12.37	.568	14.43	.47	11.94	.75	19.05	8	3.6	5000	1000	<i>T-6-X</i>
<i>T-7</i>	.580	14.73	.667	16.94	.518	13.16	.605	15.37	.50	12.70	.81	20.57	9	4.0	5000	1000	<i>T-7</i>
<i>T-7-X</i>	.610	15.49	.695	17.65	.549	13.95	.634	16.10	.50	12.70	.84	21.34	10	4.5	5000	1000	<i>T-7-X</i>
<i>T-8</i>	.640	16.26	.727	18.47	.578	14.68	.664	16.87	.50	12.70	.88	22.35	10	4.5	5000	1000	<i>T-8</i>
<i>T-8-S</i>	.669	16.99	.694	17.63	.613	15.57	.638	16.21	.19	4.83	.75	19.05	7	3.1	5000	1000	<i>T-8-S</i>
<i>T-8-X</i>	.675	17.15	.755	19.18	.613	15.57	.693	17.60	.50	12.70	.88	22.35	10	4.5	5000	1000	<i>T-8-X</i>
<i>T-9</i>	.690	17.53	.788	20.02	.628	15.95	.726	18.44	.56	14.22	.94	23.88	13	5.8	5000	1000	<i>T-9</i>
<i>T-9-S</i>	.740	18.80	.765	19.43	.678	17.22	.703	17.86	.19	4.83	.88	22.35	7	3.1	5000	1000	<i>T-9-S</i>
<i>T-9-X</i>	.725	18.42	.823	20.91	.663	16.84	.761	19.33	.56	14.22	.97	24.64	13	5.8	5000	1000	<i>T-9-X</i>
<i>T-10</i>	.750	19.05	.848	21.54	.687	17.45	.785	19.94	.56	14.22	1.00	25.40	13	5.8	5000	1000	<i>T-10</i>
<i>T-11</i>	.802	20.37	.911	23.14	.740	18.80	.849	21.57	.63	16.00	1.06	26.93	15	6.8	5000	1000	<i>T-11</i>
<i>T-11-X</i>	.815	20.70	.930	23.62	.753	19.13	.868	22.05	.63	16.00	1.09	27.69	16	7.2	5000	1000	<i>T-11-X</i>
<i>T-11-S</i>	.837	21.26	.890	22.61	.757	19.23	.810	20.57	.22	5.59	1.05	26.67	12	5.4	5000	1000	<i>T-11-S</i>
<i>T-12</i>	.866	22.00	.975	24.77	.803	20.40	.912	23.17	.63	16.00	1.13	28.70	17	7.6	5000	1000	<i>T-12</i>
<i>T-12-X</i>	.915	23.24	1.040	26.42	.855	21.72	.980	24.89	.69	17.53	1.16	29.47	18	8.1	5000	1000	<i>T-12-X</i>
<i>T-13-A</i>	.960	24.38	1.047	26.59	.900	22.86	.987	25.07	.50	12.70	1.19	30.23	17	7.6	5000	1000	<i>T-13-A</i>
<i>T-13</i>	.964	24.49	1.090	27.69	.901	22.89	1.027	26.09	.75	19.05	1.25	31.75	12	5.4	2500	500	<i>T-13</i>
<i>T-13-X</i>	.995	25.27	1.145	29.08	.933	23.70	1.083	27.51	.75	19.05	1.31	33.28	12	5.4	2500	500	<i>T-13-X</i>
<i>T-14</i>	1.094	27.79	1.215	30.86	1.031	26.19	1.152	29.26	.75	19.05	1.41	35.82	14	6.3	2500	500	<i>T-14</i>
<i>T-14-X</i>	1.175	29.85	1.284	32.61	1.113	28.27	1.222	31.04	.63	16.00	1.44	36.58	14	6.3	2500	500	<i>T-14-X</i>
<i>T-15-A</i>	.836	21.24	1.305	33.15	.777	19.74	1.247	31.68	1.06	26.93	1.43	36.32	15	6.8	2500	500	<i>T-15-A</i>
<i>T-15</i>	1.224	31.09	1.355	34.42	1.161	29.49	1.292	32.82	.75	19.05	1.50	38.10	15	6.8	2500	500	<i>T-15</i>
<i>T-15-X</i>	1.235	31.37	1.360	34.55	1.173	29.80	1.298	32.97	.81	20.57	1.50	38.10	16	7.2	2500	500	<i>T-15-X</i>
<i>T-15-S</i>	1.285	32.64	1.346	34.19	1.227	31.17	1.288	32.72	.38	9.65	1.47	37.34	19	8.6	5000	1000	<i>T-15-S</i>
<i>T-16-A</i>	1.140	28.96	1.420	36.07	1.085	27.56	1.358	34.49	.81	20.57	1.56	39.63	14	6.3	2500	500	<i>T-16-A</i>
<i>T-16</i>	1.312	33.33	1.465	37.21	1.249	31.73	1.402	35.61	.88	22.35	1.63	41.40	19	8.6	2500	500	<i>T-16</i>
<i>T-16-S</i>	1.395	35.43	1.465	37.21	1.345	34.16	1.405	35.69	.39	9.91	1.59	40.39	5	2.2	1000	200	<i>T-16-S</i>
<i>T-17-A</i>	1.239	31.47	1.507	38.28	1.169	29.69	1.437	36.50	.75	19.05	1.63	41.40	16	7.2	2500	500	<i>T-17-A</i>
<i>T-17</i>	1.447	36.76	1.600	40.64	1.384	35.15	1.537	39.04	.88	22.35	1.75	44.45	9	4.0	1000	200	<i>T-17</i>
<i>T-17-S</i>	1.513	38.43	1.600	40.64	1.451	36.86	1.537	39.04	.50	12.70	1.75	44.45	16	7.2	2500	500	<i>T-17-S</i>
<i>T-18</i>	1.560	39.63	1.682	42.72	1.498	38.05	1.620	41.15	.75	19.05	1.88	47.75	9	4.0	1000	200	<i>T-18</i>
<i>T-18-X</i>	1.630	41.40	1.750	44.45	1.568	39.83	1.688	42.88	.75	19.05	1.94	49.28	10	4.5	1000	200	<i>T-18-X</i>
<i>T-19</i>	1.750	44.45	1.880	47.75	1.688	42.88	1.818	46.18	.75	19.05	2.00	50.80	9	4.0	1000	200	<i>T-19</i>
<i>T-20-A</i>	1.440	36.58	1.895	48.13	1.378	35.00	1.833	46.56	1.28	32.51	2.06	52.33	11	4.9	1000	200	<i>T-20-A</i>
<i>T-20</i>	1.780	45.21	1.950	49.53	1.718	43.64	1.888	47.96	1.00	25.40	2.13	54.10	12	5.4	1000	200	<i>T-20</i>
<i>T-20-S</i>	1.781	45.24	1.805	45.85	1.722	43.74	1.746	44.35	.38	9.65	2.00	50.80	7	3.1	1000	200	<i>T-20-S</i>
<i>T-210</i>	1.844	46.84	2.000	50.80	1.781	45.24	1.938	49.23	1.00	25.40	2.13	54.10	12	5.4	1000	200	<i>T-210</i>



WHEN PLUGGING
"B" Dim. must be at least 1% larger than hole to be plugged. Minimum .020".

Note: part number in *red italics* also available from stock in FlexTemp/Green

non-threaded PLUGS



Applicable Specs.: MIL-C-5501/7 (MIL-C-52078), NAS-834

T Series (cont'd)

Caplug No.	Dimensions										Packaging				Caplug No.		
	A		B		C		D		E		F		Standard Carton			Mini Pak Quantity	
	in	mm	in	mm	in	mm	in	mm	in	mm	in	mm	Shipping Wt.(Approx.) lbs	kgs			No. of Pieces
T-21-A	1.738	44.15	2.163	54.94	1.668	42.37	2.093	53.16	1.18	29.97	2.31	58.68	13	5.8	1000	200	T-21-A
T-21	1.900	48.26	2.076	52.73	1.837	46.66	2.013	51.13	1.00	25.40	2.25	57.15	14	6.3	1000	200	T-21
T-220	1.975	50.17	2.132	54.15	1.913	48.59	2.070	52.58	1.00	25.40	2.25	57.15	13	5.8	1000	200	T-220
T-22-A	1.935	49.15	2.310	58.68	1.875	47.63	2.255	57.28	.85	21.59	2.47	62.74	12	5.4	1000	200	T-22-A
T-22-S	2.015	51.18	2.147	54.54	1.953	49.61	2.085	52.96	.75	19.05	2.31	58.68	12	5.4	1000	200	T-22-S
T-221	2.067	52.50	2.243	56.97	2.005	50.93	2.181	55.40	1.00	25.40	2.44	61.98	13	5.8	1000	200	T-221
T-230	2.136	54.26	2.312	58.73	2.074	52.68	2.250	57.15	1.00	25.40	2.56	65.03	15	6.8	1000	200	T-230
T-24-S	2.230	56.64	2.260	57.41	2.168	55.07	2.198	55.83	.50	12.70	2.50	63.50	12	5.4	1000	200	T-24-S
T-25-A	2.125	53.98	2.406	61.11	2.063	52.40	2.344	59.54	1.00	25.40	2.53	64.26	14	6.3	1000	200	T-25-A
T-240	2.298	58.37	2.464	62.59	2.235	56.77	2.401	60.99	1.00	25.40	2.63	66.80	10	4.5	500	100	T-240
T-250	2.395	60.84	2.602	66.09	2.333	59.26	2.540	64.52	1.03	26.16	2.81	71.38	10	4.5	500	100	T-250
T-33-A1	2.480	62.99	2.644	67.16	2.418	61.42	2.582	65.59	.63	16.00	2.78	70.61	14	6.3	1000	200	T-33-A1
T-33-A	2.307	58.60	2.650	67.31	2.245	57.03	2.588	65.74	1.25	31.75	2.78	70.61	10	4.5	500	100	T-33-A
T-43-A	2.457	62.41	2.750	69.85	2.395	60.84	2.688	68.28	1.00	25.40	2.88	73.15	11	4.9	500	100	T-43-A
T-43-X	2.555	64.90	2.690	68.33	2.493	63.32	2.628	66.75	.63	16.00	2.88	73.15	16	7.2	1000	200	T-43-X
T-44	2.641	67.08	2.790	70.87	2.579	65.51	2.728	69.29	.75	19.05	2.94	74.68	9	4.0	500	100	T-44
T-45-A	2.760	70.11	2.990	75.95	2.685	68.20	2.947	74.86	1.00	25.40	3.13	79.51	10	4.5	500	100	T-45-A
T-500	2.849	72.37	2.980	75.69	2.787	70.79	2.918	74.12	.75	19.05	3.25	82.55	10	4.5	500	100	T-500
T-53	2.975	75.57	3.103	78.82	2.915	74.04	3.041	77.24	.75	19.05	3.34	84.84	11	4.9	500	100	T-53
T-55-A	2.982	75.75	3.245	82.43	2.912	73.97	3.175	80.65	1.00	25.40	3.38	85.86	12	5.4	500	100	T-55-A
T-57-A	3.090	78.49	3.370	85.60	3.020	76.71	3.300	83.82	1.00	25.40	3.50	88.90	15	6.8	500	100	T-57-A
T-501	3.325	84.46	3.457	87.81	3.245	82.43	3.377	85.78	.75	19.05	3.63	92.21	9	4.0	250	50	T-501
T-96-A	3.270	83.06	3.562	90.48	3.200	81.28	3.492	88.70	1.13	28.70	3.69	93.73	9	4.0	250	50	T-96-A
T-1050	3.47	88.14	3.60	91.44	3.41	86.62	3.54	89.92	.75	19.05	3.88	98.56	16	7.2	500	100	T-1050
T-1051	3.55	90.17	3.73	94.75	3.48	88.40	3.66	92.97	1.00	25.40	4.00	101.60	10	4.5	250	50	T-1051
T-1052	3.68	93.48	3.80	96.52	3.61	91.70	3.73	94.75	.75	19.05	4.00	101.60	9	4.0	250	50	T-1052
T-502	3.79	96.27	3.92	99.57	3.71	94.24	3.84	97.54	.75	19.05	4.12	104.65	9	4.0	250	50	T-502
T-1063	3.93	99.83	4.07	103.38	3.86	98.05	4.00	101.60	.75	19.05	4.38	111.26	10	4.5	250	50	T-1063
T-1064	4.02	102.11	4.14	105.16	3.94	100.08	4.07	103.38	.75	19.05	4.53	115.07	11	4.9	250	50	T-1064
T-1067	4.09	103.89	4.32	109.73	4.01	101.86	4.24	107.70	1.25	31.75	4.62	117.35	25	11.2	250	100	T-1067
T-1070	4.27	108.46	4.43	112.53	4.18	106.18	4.34	110.24	.88	22.35	4.88	123.96	15	6.8	250	100	T-1070
T-1072	4.37	111.00	4.62	117.35	4.29	108.97	4.54	115.32	1.00	25.40	5.00	127.01	27	12.1	250	50	T-1072
T-1076	4.64	117.86	4.85	123.19	4.57	116.08	4.78	121.42	.88	22.35	5.25	133.36	25	11.2	250	50	T-1076
T-1078	4.79	121.67	4.97	126.24	4.71	119.64	4.89	124.21	1.00	25.40	5.38	136.66	16	7.2	250	50	T-1078
T-1079	4.91	124.72	5.09	129.29	4.83	122.69	5.01	127.26	1.00	25.40	5.50	139.71	15	6.8	250	50	T-1079
T-1080	4.99	126.75	5.20	132.09	4.92	124.97	5.10	129.55	1.00	25.40	5.63	143.01	16	7.2	250	50	T-1080
T-1084	5.18	131.58	5.36	136.15	5.11	129.80	5.29	134.37	1.00	25.40	5.88	149.36	19	8.6	250	50	T-1084
T-1086	5.33	135.39	5.49	139.45	5.21	132.34	5.37	136.40	.88	22.35	5.88	149.36	19	8.6	250	50	T-1086
T-1088	5.47	138.94	5.62	142.75	5.39	136.91	5.54	140.72	1.00	25.40	6.13	155.71	18	8.1	250	50	T-1088
T-1090	5.57	141.48	5.75	146.06	5.49	139.45	5.67	144.02	1.00	25.40	6.19	157.23	19	8.6	250	50	T-1090
T-1092	5.70	144.79	5.87	149.10	5.61	142.50	5.79	147.07	.98	24.89	6.25	158.76	19	8.6	250	50	T-1092
T-1097	6.01	152.66	6.18	156.98	5.92	150.37	6.10	154.95	1.00	25.40	6.62	168.15	19	8.6	250	50	T-1097
T-1100	6.18	156.98	6.35	161.30	6.09	154.69	6.26	159.01	1.00	25.40	6.75	171.46	10	4.5	100	20	T-1100
T-1103	6.40	162.57	6.56	166.63	6.33	160.79	6.49	164.85	.87	22.10	6.94	176.28	10	4.5	100	20	T-1103
T-1107	6.61	167.90	6.71	170.44	6.53	165.87	6.63	168.41	1.50	38.10	7.19	182.63	13	5.8	100	20	T-1107
T-1108-S	6.88	174.75	7.03	178.56	6.80	172.72	6.95	176.53	.50	12.70	7.67	194.82	12	5.4	100	20	T-1108-S
T-1109	7.05	179.08	7.12	180.86	6.97	177.04	7.06	179.33	1.00	25.40	7.63	193.81	14	6.3	100	20	T-1109
T-1110	7.34	186.44	7.65	194.32	7.26	184.41	7.56	192.03	1.00	25.40	7.94	201.68	13	5.8	100	20	T-1110
T-1120	7.66	194.57	7.84	199.14	7.58	192.54	7.76	197.11	1.00	25.40	8.12	206.26	12	5.4	100	20	T-1120
T-1128	7.97	202.45	8.14	206.76	7.88	200.16	8.05	204.48	1.00	25.40	8.38	212.86	13	5.8	100	20	T-1128
T-1133	8.15	207.02	8.35	212.10	8.05	204.48	8.25	209.56	1.38	35.05	8.75	222.26	10	4.5	50	10	T-1133
T-1137	8.40	213.37	8.60	218.45	8.30	210.83	8.50	215.91	1.38	35.05	9.00	228.61	10	4.5	50	10	T-1137
T-1139	8.67	220.23	8.73	221.75	8.55	217.18	8.60	218.45	1.50	38.10	9.13	231.91	11	4.9	50	10	T-1139

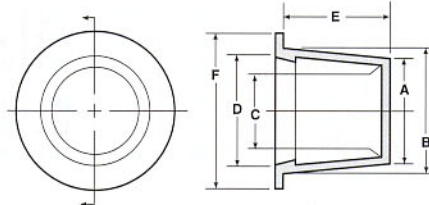

WHEN PLUGGING
"B" Dim. must be at least 1% larger than hole to be plugged. Minimum .020".



PLUGS non-threaded

WW Series Tapered Plugs with Wide, Thick Flanges



Accepted by the aircraft industry, Series WW Plugs are designed with a wide, thick flange to insure against being erroneously forced "all-the-way-through" when used as a plug. Available in fifty-four sizes, this versatile part may easily be used as a cap or plug depending upon application.

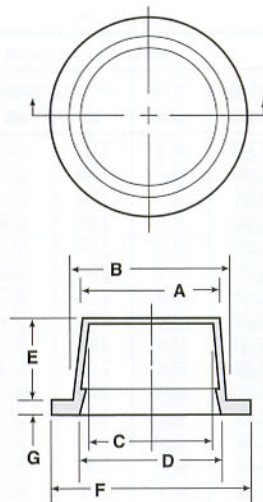
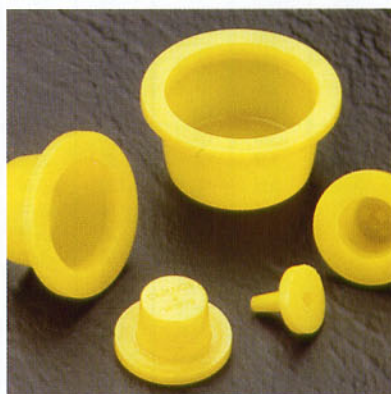

MATERIAL: Low Density Polyethylene
COLOR*: Yellow

non-threaded PLUGS



Applicable Specs.: NSA STND, NAS-816



WHEN PLUGGING
"B" Dim. must be at least 1% larger than hole to be plugged.
Minimum .020".

WW Series

Caplug No.	Dimensions												Packaging				Caplug No.		
	A		B		C		D		E		F		G		Standard Carton			Mini Pak Quantity	
	in	mm	in	mm	in	mm	in	mm	in	mm	in	mm	Shipping Wt.(Approx.) lbs	kgs	No. of Pieces				
WW-00	.116	2.95	.182	4.62	.053	1.35	.120	3.05	.37	9.40	.50	12.70	.090	2.29	5	2.2	5000	1000	WW-00
WW-0	.173	4.39	.240	6.10	.111	2.82	.177	4.50	.37	9.40	.56	14.22	.090	2.29	6	2.7	5000	1000	WW-0
WW-1	.236	5.99	.296	7.52	.174	4.42	.225	5.72	.31	7.87	.62	15.75	.090	2.29	6	2.7	5000	1000	WW-1
WW-2	.299	7.59	.365	9.27	.235	5.97	.302	7.67	.31	7.87	.68	17.27	.090	2.29	8	3.6	5000	1000	WW-2
WW-2X	.333	8.46	.392	9.96	.269	6.83	.319	8.10	.31	7.87	.72	18.29	.090	2.29	8	3.6	5000	1000	WW-2X
WW-3	.367	9.32	.418	10.62	.298	7.57	.354	8.99	.31	7.87	.75	19.05	.090	2.29	9	4.0	5000	1000	WW-3
WW-3X	.397	10.08	.447	11.35	.328	8.33	.383	9.73	.31	7.87	.78	19.81	.090	2.29	9	4.0	5000	1000	WW-3X
WW-4	.427	10.85	.475	12.07	.356	9.04	.409	10.39	.31	7.87	.81	20.57	.090	2.29	10	4.5	5000	1000	WW-4
WW-4X	.435	11.05	.509	12.93	.365	9.27	.439	11.15	.37	9.40	.83	21.08	.090	2.29	11	4.9	5000	1000	WW-4X
WW-5	.481	12.22	.547	13.89	.409	10.39	.493	12.52	.37	9.40	.87	22.10	.090	2.29	12	5.4	5000	1000	WW-5
WW-5X	.500	12.70	.563	14.30	.440	11.18	.500	12.70	.37	9.40	.89	22.61	.090	2.29	13	5.8	5000	1000	WW-5X
WW-6	.530	13.46	.615	15.62	.468	11.89	.547	13.89	.37	9.40	.94	23.88	.090	2.29	14	6.3	5000	1000	WW-6
WW-6X	.560	14.22	.631	16.03	.497	12.62	.579	14.71	.41	10.41	.97	24.64	.090	2.29	15	6.8	5000	1000	WW-6X
WW-7	.590	14.99	.667	16.94	.518	13.16	.605	15.37	.44	11.18	1.00	25.40	.090	2.29	16	7.2	5000	1000	WW-7
WW-7X	.610	15.49	.687	17.45	.548	13.92	.635	16.13	.44	11.18	1.03	26.16	.090	2.29	16	7.2	5000	1000	WW-7X
WW-8	.628	15.95	.725	18.42	.558	14.17	.662	16.82	.44	11.18	1.06	26.93	.090	2.29	17	7.6	5000	1000	WW-8
WW-8X	.658	16.71	.750	19.05	.588	14.94	.687	17.45	.44	11.18	1.09	27.69	.090	2.29	18	8.1	5000	1000	WW-8X
WW-9	.690	17.53	.775	19.69	.620	15.75	.721	18.31	.47	11.94	1.12	28.45	.090	2.29	19	8.6	5000	1000	WW-9
WW-9X	.725	18.42	.812	20.63	.663	16.84	.761	19.33	.50	12.70	1.16	29.47	.090	2.29	21	9.4	5000	1000	WW-9X
WW-10	.755	19.18	.870	22.10	.693	17.60	.808	20.52	.50	12.70	1.18	29.97	.090	2.29	21	9.4	5000	1000	WW-10
WW-11	.820	20.83	.930	23.62	.755	19.18	.865	21.97	.53	13.46	1.25	31.75	.090	2.29	24	10.8	2500	500	WW-11
WW-11X	.825	20.96	.929	23.60	.763	19.38	.878	22.30	.56	14.22	1.25	31.75	.090	2.29	23	10.3	2500	500	WW-11X
WW-12	.867	22.02	.975	24.77	.805	20.45	.913	23.19	.56	14.22	1.28	32.51	.090	2.29	26	11.7	2500	500	WW-12
WW-12X	.915	23.24	1.035	26.29	.840	21.34	.960	24.38	.63	16.00	1.34	34.04	.090	2.29	16	7.2	2500	500	WW-12X
WW-13	.984	24.99	1.105	28.07	.919	23.34	1.040	26.42	.66	16.76	1.44	36.58	.090	2.29	16	7.2	2500	500	WW-13
WW-13B	1.094	27.79	1.215	30.86	1.031	26.19	1.132	28.75	.69	17.53	1.56	39.63	.090	2.29	18	8.1	2500	500	WW-13B
WW-14	1.110	28.20	1.233	31.32	1.043	26.49	1.157	29.39	.66	16.76	1.56	39.63	.090	2.29	19	8.6	2500	500	WW-14
WW-14X	1.150	29.21	1.284	32.61	1.108	28.14	1.205	30.61	.66	16.76	1.56	39.63	.090	2.29	18	8.1	2500	500	WW-14X
WW-15	1.237	31.42	1.382	35.10	1.167	29.64	1.288	32.72	.66	16.76	1.68	42.67	.090	2.29	21	9.4	2500	500	WW-15
WW-16	1.312	33.33	1.465	37.21	1.249	31.73	1.364	34.65	.81	20.57	1.84	46.74	.120	3.05	13	5.8	1000	200	WW-16
WW-16X	1.416	35.97	1.516	38.51	1.354	34.39	1.462	37.14	.69	17.53	1.75	44.45	.120	3.05	11	4.9	1000	200	WW-16X
WW-17	1.452	36.88	1.603	40.72	1.377	34.98	1.503	38.18	.63	16.00	1.94	49.28	.120	3.05	13	5.8	1000	200	WW-17
WW-18	1.580	40.13	1.714	43.54	1.515	38.48	1.649	41.89	.63	16.00	2.06	52.33	.120	3.05	13	5.8	1000	200	WW-18
WW-19	1.730	43.94	1.887	47.93	1.650	41.91	1.780	45.21	.63	16.00	2.31	58.68	.120	3.05	17	7.6	1000	200	WW-19
WW-200	1.810	45.98	1.975	50.17	1.730	43.94	1.895	48.13	.63	16.00	2.38	60.45	.120	3.05	18	8.1	1000	200	WW-200
WW-210	1.850	46.99	2.020	51.31	1.788	45.42	1.917	48.69	1.00	25.40	2.44	61.98	.120	3.05	11	4.9	500	100	WW-210
WW-21	1.927	48.95	2.058	52.28	1.857	47.17	1.988	50.50	.63	16.00	2.38	60.45	.120	3.05	17	7.6	1000	200	WW-21
WW-221	2.067	52.50	2.243	56.97	2.005	50.93	2.135	54.23	1.00	25.40	2.69	68.33	.120	3.05	12	5.4	500	100	WW-221
WW-230	2.136	54.26	2.312	58.73	2.074	52.68	2.250	57.15	1.00	25.40	2.75	69.85	.120	3.05	12	5.4	500	100	WW-230
WW-25A	2.125	53.98	2.406	61.11	2.063	52.40	2.344	59.54	1.00	25.40	2.69	68.33	.120	3.05	12	5.4	500	100	WW-25A
WW-240	2.298	58.37	2.464	62.59	2.235	56.77	2.370	60.20	1.00	25.40	2.88	73.15	.120	3.05	14	6.3	500	100	WW-240
WW-250	2.395	60.84	2.602	66.09	2.333	59.26	2.500	63.50	1.13	28.70	3.00	76.20	.120	3.05	14	6.3	500	100	WW-250
WW-33A	2.305	58.55	2.620	66.55	2.245	57.03	2.560	65.03	1.25	31.75	3.06	77.73	.120	3.05	8	3.6	250	50	WW-33A
WW-43A	2.475	62.87	2.725	69.22	2.405	61.09	2.650	67.31	.91	23.11	3.16	80.27	.120	3.05	8	3.6	250	50	WW-43A
WW-44	2.638	67.01	2.759	70.08	2.568	65.23	2.661	67.59	.69	17.53	3.22	81.79	.120	3.05	14	6.3	500	100	WW-44
WW-45A	2.685	68.20	2.955	75.06	2.623	66.63	2.916	74.07	1.00	25.40	3.44	87.38	.120	3.05	8	3.6	250	50	WW-45A
WW-53	2.995	76.08	3.150	80.01	2.925	74.30	3.080	78.24	.75	19.05	3.59	91.19	.120	3.05	9	4.0	250	50	WW-53
WW-55A	2.990	75.95	3.250	82.55	2.920	74.17	3.150	80.01	1.00	25.40	3.75	95.25	.120	3.05	11	4.9	250	50	WW-55A
WW-57A	3.090	78.49	3.370	85.60	3.020	76.71	3.322	84.38	1.00	25.40	3.81	96.78	.120	3.05	10	4.5	250	50	WW-57A
WW-96A	3.225	81.92	3.562	90.48	3.155	80.14	3.517	89.34	1.12	28.45	4.00	101.60	.120	3.05	11	4.9	250	50	WW-96A
WW-501	3.325	84.46	3.457	87.81	3.245	82.43	3.382	85.91	.75	19.05	3.88	98.56	.120	3.05	10	4.5	250	50	WW-501
WW-502	3.790	96.27	3.920	99.57	3.710	94.24	3.840	97.54	.75	19.05	4.34	110.24	.120	3.05	13	5.8	250	50	WW-502
WW-1064	4.011	101.88	4.135	105.03	3.937	100.00	4.061	103.15	.75	19.05	4.62	117.35	.120	3.05	6	2.7	100	20	WW-1064
WW-1076	4.640	117.86	4.847	123.12	4.566	115.98	4.775	121.29	.88	22.35	5.25	133.36	.120	3.05	7	3.1	100	20	WW-1076



PLUGS non-threaded

W Series Tapered Plugs with Wide Flanges

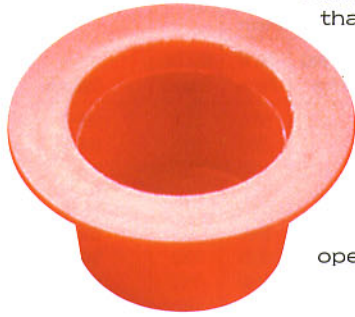

Featuring a wider flange than standard Tapered Plugs, the Series W offers added protection for bearing surfaces, and cannot be accidentally pushed all the way into or through an opening being plugged.



MATERIAL: Low Density Polyethylene
COLOR*: Red

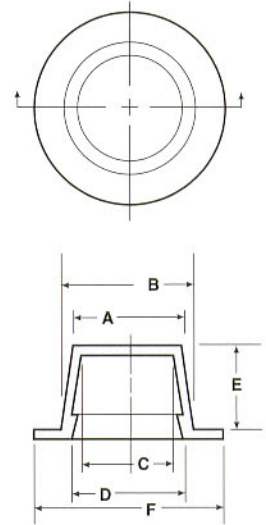

WWX Series Tapered Plugs with Extra-Wide, Extra-Thick Flanges



Accepted by the aircraft industry, Series WWX has an extra-wide flange providing extended visibility. This dummy-proof design prevents the mating component from being installed without first removing the plug. Available in thirteen sizes, this versatile part may easily be used as a cap or plug depending on application.

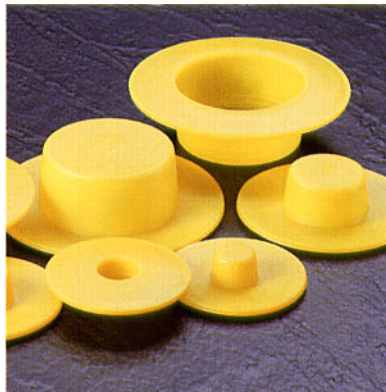

MATERIAL: Low Density Polyethylene
COLOR*: Yellow

